

CNC 鋸齒鋁棒 鋸齒鋁棒 鋸齒鋁棒

鋸齒鋁棒 鋸齒鋁棒 CNC 鋸齒鋁棒 鋸齒鋁棒.鋸齒鋁棒 鋸齒鋁棒 L/D 鋸齒鋁棒 鋸齒鋁棒 鋸齒鋁棒 鋸齒鋁棒 鋸齒鋁棒 鋸齒鋁棒 鋸齒鋁棒 鋸齒鋁棒 鋸齒鋁棒 鋸齒鋁棒 鋸齒鋁棒 鋸齒鋁棒 鋸齒鋁棒 鋸齒鋁棒 鋸齒鋁棒.鋸齒鋁棒 鋸齒鋁棒.

抗震刀杆

Boring bar

尺寸公差 Size of tolerance

规格 Specifications	尺寸/Dimension								
	直径		孔径		沉孔直径		长度		螺纹
	ØD(mm)	Tol.(mm)	ØD(mm)	Tol.(mm)	ØD2(mm)	Tol.(mm)	L(mm)	Tol.(mm)	M
Ø8	8.0	+0.40~+1.00	2.0	±2.0	4.5	-0.30~0.70	100	+0.60~+1.20	M4
Ø10	10.0	+0.40~+1.00	2.5	±2.0	5.5	-0.30~0.70	100~150	+0.60~+1.20	M5
Ø12	12.0	+0.40~+1.00	3.0	±2.0	6.5	-0.30~0.70	100~200	+0.60~+1.20	M6
Ø15	15.0	+0.60~+1.20	4.2	±2.0	8.5	-0.30~0.70	100~200	+0.80~+1.50	M8
Ø15.6	15.6	+0.60~+1.20	4.2	±2.0	8.5	-0.30~0.70	150~250	+0.80~+1.50	M8
Ø16	16.0	+0.60~+1.20	4.2	±2.0	8.5	-0.30~0.70	100~300	+0.80~+1.50	M8
Ø19	19.0	+0.80~+1.50	5.2	±2.0	10.5	-0.30~0.70	150~250	+1.00~1.80	M10
Ø20	20.0	+0.80~+1.50	5.2	±2.0	10.5	-0.30~0.70	100~300	+1.00~1.80	M10
Ø24	24.0	+1.00~+1.80	8.0	±3.0	12.5	-0.30~0.70	150~300	+1.20~+2.00	M12
Ø25	25.0	+1.00~+1.80	8.0	±3.0	12.5	-0.30~0.70	150~300	+1.20~+2.00	M12
Ø32	32.0	+1.20~+2.00	10.0	±3.0	17.0	-0.30~0.70	150~400	+1.50~2.20	M16

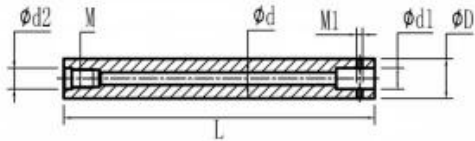

Copyright ©